

UBC

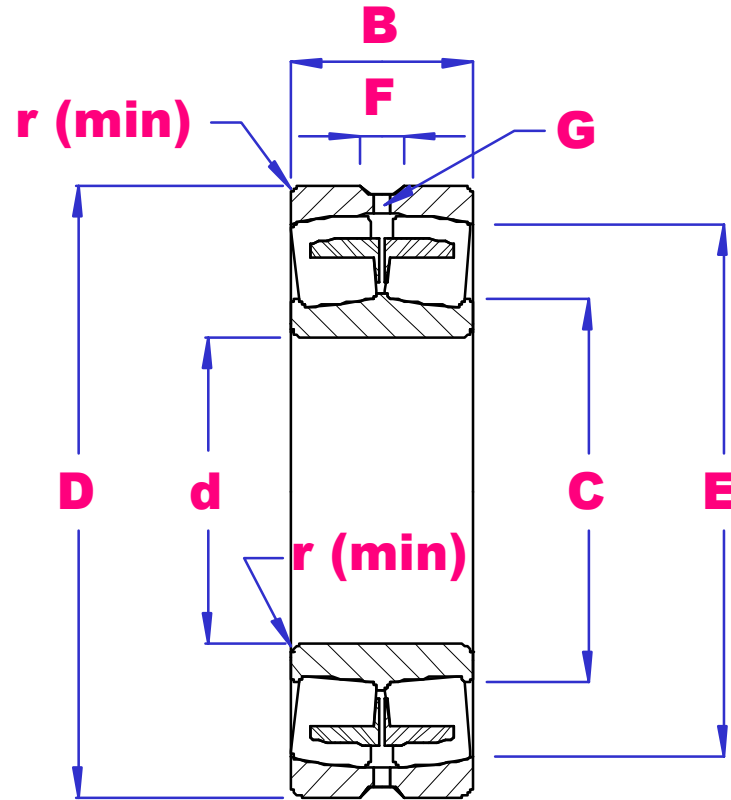

**SPHERICAL ROLLER
BEARINGS
PARALLEL BORE**



PART NO	d	D	B	r min	C	E	F	G	LOAD RATING		SPEED RATING(rpm)		WGT kg
									DkN	SkN	GREASE	OIL	
239/560	560	750	140	5.0	621	693	22.3	12	3050	7200	340	430	177
230/560		820	195	6.0	644	741	22.3	9	4950	10500	320	410	363
240/560		820	258	6.0	640	721	22.3	12	5700	13200	220	300	471
231/560		920	280	7.5	677	803	22.3	12	7590	15700	240	320	756
241/560		920	355	7.5	634	796	22.3	12	10000	20100	120	160	958
232/560		1030	365	9.5	705	877	22.3	12	11200	21000	190	260	1380
239/600		600	800	150	5.0	668	742	22.3	12	3260	8400	320	400
249/600	800		200	5.0	666	728	22.3	12	4070	11200	320	400	287
230/600	870		200	6.0	685	787	22.3	9	5170	11600	300	380	442
240/600	870		272	6.0	680	770	22.3	12	8100	16500	220	300	560
231/600	980		300	7.5	717	855	22.3	12	8900	18800	180	250	894
241/600	980		375	7.5	709	827	22.3	8	10000	21600	110	150	1140
232/600	1090		388	9.5	750	920	22.3	12	12500	25000	190	260	1568

238/630	630	780	112	4.0	682	738	16.7	9	2200	6300	300	380	124
239/630		850	165	6.0	705	786	22.3	12	3550	9750	280	360	280
230/630		920	212	7.5	721	831	22.3	9	5670	12800	260	340	471
240/630		920	290	7.5	722	815	22.3	10	7350	17100	220	300	661
231/630		1030	315	7.5	756	918	22.3	12	10000	21000	180	250	1080
241/630		1030	400	7.5	736	885	22.3	12	12500	27200	160	210	1440
238/670	670	820	112	4.0	722	778	16.7	9	2210	6300	270	350	136
248/670		820	150	4.0	716	771	16.7	9	3100	9600	270	350	178
239/670		900	170	6.0	743	831	22.3	12	4400	10600	260	340	313
230/670		980	230	7.5	760	885	22.3	12	6900	15000	240	310	601
240/670		980	308	7.5	760	866	22.3	12	9500	20000	190	270	807
231/670		1090	336	7.5	801	958	22.3	12	11000	22500	175	240	1280
241/670		1090	412	7.5	786	934	22.3	12	14000	31500	150	190	1560
232/670		1220	438	12.0	832	1027	22.3	12	15000	32000	160	210	2300
238/710	710	870	118	4.0	761	824	22.3	12	2680	7550	260	340	156
239/710		950	180	6.0	787	882	22.3	12	5000	12000	240	310	365
249/710		950	243	6.0	791	864	22.3	12	6200	17000	200	280	500
230/710		1030	236	7.5	814	939	22.3	12	6300	16200	220	300	669
240/710		1030	315	7.5	806	918	22.3	12	9300	22500	180	250	910
231/710		1150	345	9.8	851	1016	22.3	12	12000	25800	170	220	1480
241/710		1150	438	9.5	838	982	22.3	12	13200	31000	110	140	1791
232/710		1280	450	12.0	876	1096	22.3	12	17500	34400	160	210	2640
238/750	750	920	128	5.0	806	873	22.3	12	2950	8600	240	310	188
248/750		920	170	5.0	808	864	22.3	12	3550	10900	220	300	249
239/750		1000	185	6.0	831	930	22.3	12	5800	13500	210	290	426
249/750		1000	250	6.0	830	916	22.3	12	7600	18200	180	250	566
230/750		1090	250	7.5	847	987	22.3	12	7000	17900	200	280	789
240/750		1090	335	7.5	852	970	22.3	12	10000	24800	170	220	1100
231/750		1220	365	9.5	898	1080	22.3	12	13500	28800	160	210	1760
241/750		1220	475	9.5	872	1039	22.3	12	16000	37000	130	170	2195
232/750		1360	475	15.0	930	1145	22.3	12	16390	36000	90	120	3100
248/800		800	980	180	5.0	860	920	22.3	12	4150	13000	170	220
239/800	1060		195	6.0	883	985	22.3	12	6350	14200	190	270	480
249/800	1060		258	6.0	880	971	22.3	12	7800	19500	175	240	648
230/800	1150		258	7.5	900	1029	22.3	12	8090	19100	170	220	894
240/800	1150		345	7.5	900	1029	22.3	12	10300	24600	170	220	1092
231/800	1280		375	9.5	948	1140	22.3	12	14500	31000	150	190	1960
241/800	1280		475	9.5	938	1102	22.3	12	16300	37100	130	170	2350