

UBC

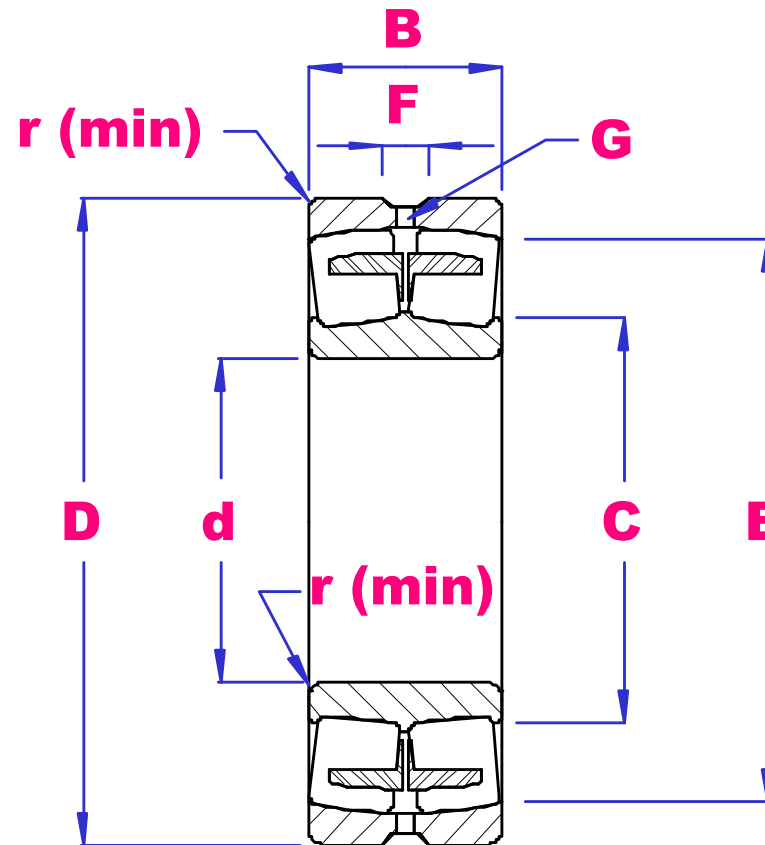

SPHERICAL ROLLER BEARINGS PARALLEL BORE



PART NO	d	D	B	r min	C	E	F	G	LOAD RATING		SPEED RATING(rpm)		WGT kg
									DkN	SkN	GREASE	OIL	
22205	25	52	18	1.0	31	46	4.8	2.0	41	43	8000	10000	0.15
22206	30	62	20	1.0	36	56	4.8	2.0	55	59	6600	8600	0.25
21306		72	19	1.1	37	65	-	-	52	51	4500	6000	0.38
22207	35	72	23	1.1	42	65	4.8	2.0	63.5	82	6400	7800	0.38
21307		80	21	1.5	44	71	-	-	70	75	4000	5800	0.51
22208	40	80	23	1.1	50.4	69	5.5	2.0	68.5	74.5	6000	7500	0.53
21308		90	23	1.5	56	74	-	-	67.5	73.5	3800	6000	0.71
22308		90	33	1.5	56	74	5.5	2.5	105	130	4500	5600	1.01
22209	45	85	23	1.1	57.6	73	5.5	2.0	80.5	95	5300	6700	0.63
21309		100	25	1.5	63	81.4	5.5	2.0	80.5	92	4500	5500	0.95
22309		100	36	1.5	63	81.4	5.5	2.5	127	168	3800	4800	1.52

22210	50	90	23	1.1	62.2	78.3	5.5	2.0	81	95	5000	6300	0.63
21310		110	27	2.0	69	90.6	5.5	2.0	95	96	4200	4800	1.24
22310		110	40	2.0	69	90.6	5.5	2.5	157	208	3400	4300	2.17
22211	55	100	25	1.5	68.8	87.3	5.5	2.0	90.5	119	4500	5600	0.88
21311		120	29	2.0	75	99.5	5.5	2.0	120	132	3800	4300	1.62
22311		120	43	2.0	75	99.5	5.5	2.5	175	230	3200	4000	2.62
22212	60	110	28	1.5	75.2	95	5.5	2.0	110	154	4000	5000	1.02
21312		130	31	2.1	81.4	108	5.5	2.0	163	152	3400	4000	1.98
22312		130	46	2.1	81.4	108	5.5	2.5	212	284	3000	3800	3.33
22213	65	120	31	1.5	81.5	103	5.5	2.5	135	193	3800	4800	1.56
21313		140	33	2.1	88.6	119	5.5	2.5	157	200	2800	3600	2.58
22313		140	48	2.1	88.6	116	5.5	3.0	238	325	2600	3400	4.91
22214	70	125	31	1.5	86.8	109	6.0	2.5	141	205	3600	4500	1.83
21314		150	35	2.1	95.8	125	6.0	2.5	216	258	2600	3400	2.48
22314		150	51	2.1	95.8	125	8.3	4.0	300	360	2400	3200	5.23
22215	75	130	31	1.5	92	114	5.5	2.5	139	208	3400	4300	1.71
21315		160	37	2.1	101	133	5.5	2.5	236	280	2400	3200	3.62
22315		160	55	2.1	101	133	8.3	4.0	325	420	2200	3000	5.44
22216	80	140	33	2.0	98.9	98.9	5.5	2.5	150	225	3200	4000	2.11
21316		170	39	2.1	109	109	5.5	2.5	255	315	2200	3000	4.32
22316		170	58	2.1	109	109	8.3	4.0	345	495	2000	2800	7.4
22217	85	150	36	2.0	105	132	6.5	3.0	175	254	3000	3800	2.71
21317		180	41	3.0	115	150	6.5	3.0	290	360	2100	2400	5.22
22317		180	60	3.0	115	150	8.3	4.0	375	540	1900	2600	8.11
22218	90	160	40	2.0	111	139	8.3	2.5	188	258	2600	3400	3.45
23218		160	52.4	2.0	112	136	5.5	2.5	338	475	1900	2600	4.75
21318		190	43	3.0	123	159	5.5	2.5	315	400	1900	2600	6.22
22318		190	64	3.0	123	159	8.3	5.0	420	625	1800	2400	11.3
22219	95	170	43	2.1	119	148	8.3	3.0	245	375	2400	3200	4.57
21319		200	45	3.0	128	167	8.3	3.0	330	420	1900	2600	7.45
22319		200	67	3.0	128	167	8.3	5.0	465	685	1800	2400	10.5
23920	100	140	30	1.1	106	133	5.5	2.5	132	225	2600	3400	1.46
23020		150	37	1.5	116	135	5.5	3.0	215	400	2400	3200	2.55
23120		165	52	2.0	121	143	5.5	3.0	287	510	2000	2800	4.42
22220		180	46	2.1	124	156	8.3	3.0	277	525	2200	3000	5.11
23220		180	60.3	2.1	125	153	8.3	4.0	400	570	1700	2200	6.35
21320		215	47	3.0	138	179	8.3	5.0	360	495	1700	2200	9.15
22320		215	73	3.0	138	179	8.3	5.0	540	815	1700	2200	13.6