

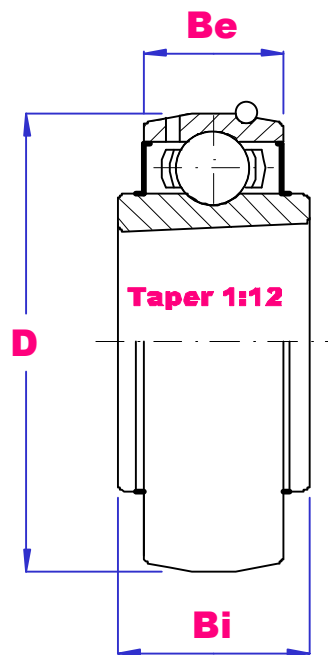

UBC

UK300 SERIES BEARING INSERT



PART NO	D mm	Bi mm	Load D-kN	Load S-kN	Max Rpm	Wgt kg
UK305	62	26	21.2	10.85	5200	0.40
UK306	72	29	26.7	14.95	4300	0.46
UK307	80	31	33.5	19.14	3900	0.54
UK308	90	34	40.5	23.95	3400	0.81
UK309	100	37	53.2	32.18	3000	1.19
UK310	110	40	62.1	38.44	2700	1.38
UK311	120	43	71.5	44.95	2500	1.78
UK312	130	46	82.1	52.22	2300	2.06
UK313	140	48	92.5	59.88	2150	2.71
UK314	150	51	104.2	68.14	2000	3.28
UK315	160	54	112.8	77.11	1900	3.98
UK316	170	57	122.9	86.47	1800	4.55
UK317	180	60	133.2	96.88	1700	5.44
UK318	190	63	142.9	107.5	1600	6.25
UK319	200	66	153.2	118.8	1500	7.31
UK320	215	72	172.7	140.8	1400	8.82
UK322	240	80	204.5	178.7	1250	11.7
UK324	260	86	207.4	185.5	1200	14.8
UK326	280	92	228.8	214.7	1100	18.4
UK328	300	98	253.6	246.7	1000	22.9

SUITABLE ADAPTOR SLEEVES H2300,HE2300,HX2300,HS2300,HA2300