

# UBC

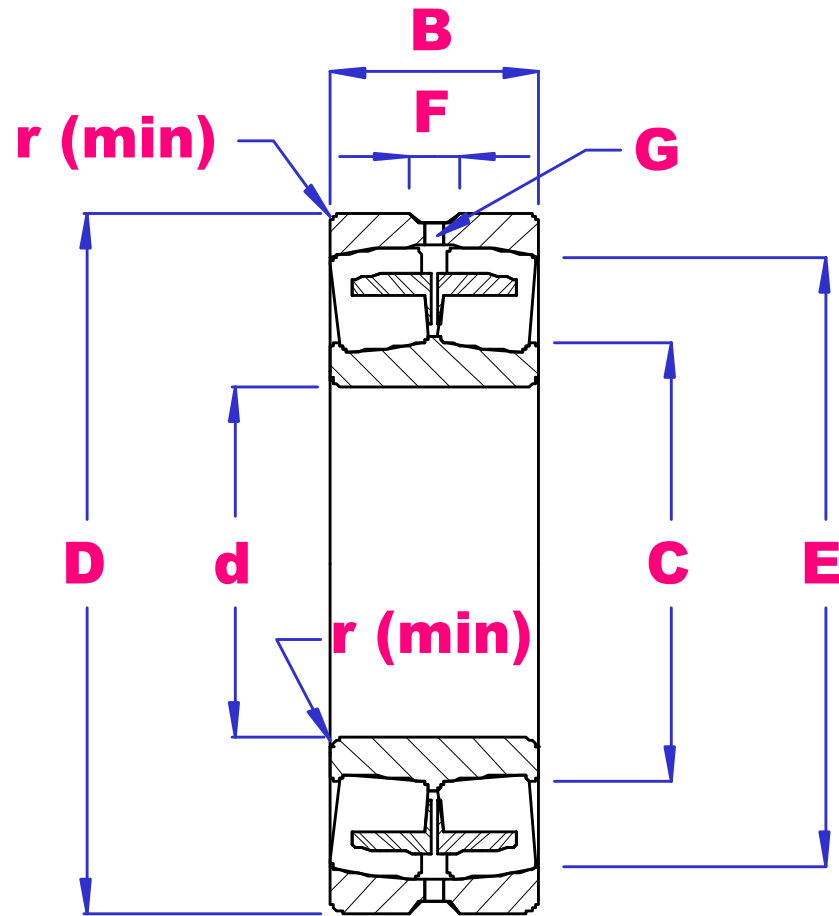

**SPHERICAL ROLLER BEARINGS  
PARALLEL BORE**



PART NO	d	D	B	r min	C	E	F	G	LOAD RATING		SPEED RATING(rpm)		WGT kg
									DkN	SkN	GREASE	OIL	
23922	110	150		1.1	110	143	-	-					
23022		170	45	2.0	128	150	7.5	3.0	253	460	2200	3000	3.54
23122		180	56	2.0	132	156	7.5	3.0	325	580	1900	2600	5.73
24122		180	69	2.0	131	153	7.5	3.0	425	750	1000	1400	6.92
22222		200	53	2.1	139	173	8.3	4.0	385	625	2000	2800	7.24
23222		200	69.8	2.1	138	168	12	5.0	490	720	1600	2000	9.83
22322		240	80	3.0	151	197	13.9	6.0	630	955	1600	2000	18.7
23924	120	165		1.1	128	152	-	-					
23024		180	46	2.0	139	162	5.5	3.0	263	495	2000	2800	4.32
24024		180	60	2.0	139	158	5.5	3.0	325	660	1600	2000	5.83

<b>23124</b>		200	62	2.0	146	174	5.5	3.0	405	715	1800	2400	8.22
<b>24124</b>		200	80	2.0	146	167	5.5	3.0	495	925	900	1200	10.6
<b>22224</b>		215	58	2.1	149	187	11.1	4.0	425	680	1900	2600	9.76
<b>23224</b>		215	76	2.1	150	182	8.3	5.0	535	940	1500	1900	12.1
<b>22324</b>		260	86	3.0	165	215	13.9	6.0	720	1100	1400	1800	23.3
<b>23926</b>	<b>130</b>	180	37	1.5	138	168	-	-					2.87
<b>23026</b>		200	52	2.0	153	179	9.5	4.0	340	350	1900	2600	7.05
<b>24026</b>		200	69	2.0	153	185	9.5	4.0	405	715	1400	1800	8.22
<b>23126</b>		210	64	2.0	156	183	8.3	4.0	430	790	1700	2200	10.7
<b>24126</b>		210	80	3.0	156	200	8.3	4.0	530	920	850	1100	11.1
<b>22226</b>		230	64	3.0	162	200	10	5.0	490	805	1800	2400	12.4
<b>23226</b>		230	80	3.0	161	194	12	5.0	670	1020	1300	1700	15.8
<b>22326</b>		280	93	4.0	178	232	16.7	6.0	840	1300	1300	1700	18.1
<b>23928</b>	<b>140</b>	190	37	1.5	148	178	-	-					
<b>23028</b>		210	53	2.0	162	188	8.3	4.5	365	705	1800	2400	6.68
<b>24028</b>		210	69	2.0	162	186	8.3	5.0	435	790	1300	1600	8.95
<b>23128</b>		225	68	2.1	166	196	8.3	4.5	490	935	1600	2000	10.9
<b>24128</b>		225	85	2.1	165	192	8.3	4.5	580	1180	850	1100	13.5
<b>22228</b>		250	68	3.0	176	218	11.1	5.0	560	930	1700	2200	16.2
<b>23228</b>		250	88	3.0	173	215	15	6.0	910	1365	1200	1600	19.7
<b>22328</b>		300	102	4.0	191	249	16.7	7.0	1210	1950	1100	1500	36.2
<b>23930</b>	<b>150</b>	210		2.0	152	192	-	-					
<b>23030</b>		225	56	2.1	174	201	8.3	4.5	400	795	1700	2200	8.01
<b>24030</b>		225	75	2.1	175	196	5.5	3.0	500	1050	1300	1700	9.39
<b>23130</b>		250	80	2.1	182	212	11.1	5.0	745	685	1400	1800	16.5
<b>24130</b>		250	100	2.1	182	218	8.3	4.5	855	1435	800	1000	20.1
<b>22230</b>		270	73	3.0	189	234	12	6.0	630	1050	1600	2000	18.7
<b>23230</b>		270	96	3.0	188	228	11.1	6.0	950	1550	1100	1500	26.6
<b>22330</b>		320	108	4.0	203	265	16.7	9.0	1120	1810	1000	1400	41.5
<b>23932</b>	<b>160</b>	220	45	2.0	170	210	-	-					
<b>23032</b>		240	60	2.1	186	216	8.3	5.0	445	875	1700	2200	10.0
<b>24032</b>		240	80	2.1	183	209	8.3	5.0	570	1210	1100	1500	13.2
<b>23132</b>		270	86	2.1	195	234	13.9	6.0	765	1430	1300	1700	21.9
<b>24132</b>		270	109	2.1	193	225	8.3	4.0	865	1690	700	900	24.6
<b>22232</b>		290	80	3.0	201	249	13.9	7.0	750	1300	1500	1900	24.3
<b>23232</b>		290	104	3.0	200	244	13.9	7.0	955	1770	1000	1400	29.2
<b>22332</b>		340	114	4.0	216	284	16.7	7.0	1270	2050	950	1300	52.5