

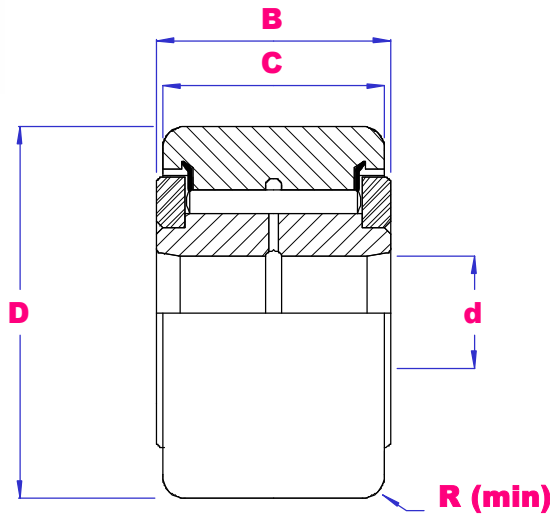

UBC

INCH YOKE ROLLERS



PART NO	d	D	B	C	r min	Load D-kN	Load S-kN	Max rpm	Wgt g
CYR3/4S	1/4 6.35	3/4 19.05	9/16 14.288	1/2 12.7	1/32 0.794	8.9	12.5	8500	27
CYR7/8S	1/4 6.35	7/8 22.225	9/16 14.288	1/2 12.7	1/32 0.794	8.9	12.5	8500	36
CYR1S	5/16 7.938	1 25.4	11/16 17.463	5/8 15.875	3/64 1.191	13.3	23.1	6300	68
CYR1.1/8S	5/16 7.938	1.1/8 28.575	11/16 17.463	5/8 15.875	1/16 1.588	13.3	23.1	6300	77
CYR1.1/4S	3/8 9.525	1.1/4 31.75	13/16 20.638	3/4 19.05	1/16 1.588	24.0	32.3	5500	109
CYR1.3/8S	3/8 9.525	1.3/8 34.925	13/16 20.638	3/4 19.05	1/16 1.588	24.0	32.3	5500	136
CYR1.1/2S	7/16 11.112	1.1/2 38.1	15/16 23.813	7/8 22.225	1/16 1.588	28.7	40.9	4700	186
CYR1.5/8S	7/16 11.112	1.5/8 41.275	15/16 23.813	7/8 22.225	1/16 1.588	28.7	40.9	4700	227
CYR1.3/4S	1/2 12.7	1.3/4 44.45	1.1/16 26.988	1 25.4	1/16 1.588	35.9	56.7	4000	290
CYR1.7/8S	1/2 12.7	1.7/8 47.625	1.1/16 26.988	1 25.4	1/16 1.588	35.9	56.7	4000	363
CYR2S	5/8 15.875	2 50.8	1.5/16 33.338	1.1/4 31.75	1/16 1.588	46.6	82.2	3600	476
CYR2.1/4S	5/8 15.875	2.1/4 57.15	1.5/16 33.338	1.1/4 31.75	1/16 1.588	46.6	82.2	3600	600
CYR2.1/2S	3/4 19.05	2.1/2 63.5	1.9/16 39.688	1.1/2 38.1	1/16 1.588	62.6	119	3000	816
CYR2.3/4S	3/4 19.05	2.3/4 69.85	1.9/16 39.688	1.1/2 38.1	1/16 1.588	62.6	119	3000	1025
CYR3S	1 25.4	3 76.2	1.13/16 46.038	1.3/4 44.45	3/32 2.382	78.6	174	2400	1410
CYR3.1/2S	1.1/8 28.575	3.1/2 88.9	2.1/16 52.388	2 50.8	3/32 2.382	114	242	2100	2250
CYR4S	1.1/4 31.75	4 101.6	2.5/16 58.738	2.1/4 57.15	3/32 2.382	144	321	1900	3200