



# UBC

## WATERPUMP / INTEGRAL SHAFT BEARINGS



Quality  
Endorsed  
Company  
ISO 9001:2000  
LIC QEC20818

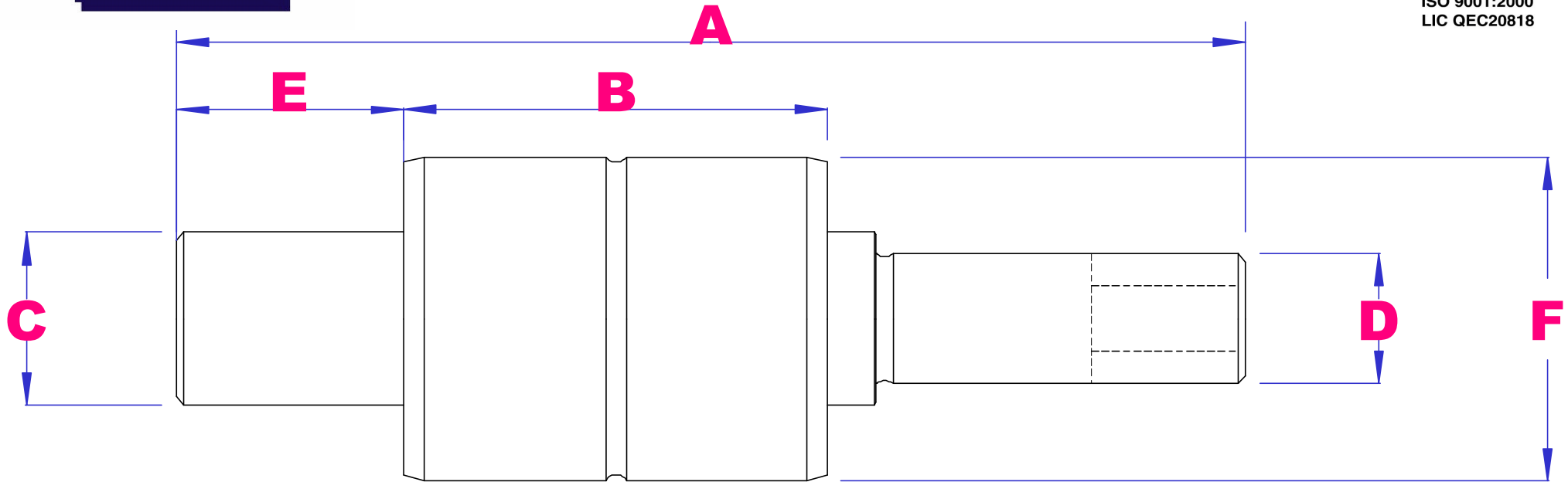

UBC PART NO.	A	B	C	D	E	F	SPECIAL FEATURES
NBWP/IB07330	75.00	39.00	15.875	15.875	4.00	29.972	Grease Nipple & Groove - 1/4 Dia. Hole 13mm from shaft end
W2450-2/F	86.00	39.00	15.875	15.875	4.00	29.972	
BWF30-119Z	98.50	39.00	15.875	15.875/12mm	38.00	29.972	Shaft Dia reduces to 12mm Dia. 33.5mm from end of shaft.
FPS61	166.12	38.86	15.875	15.875	63.246	29.972	Soft Shaft - Induction hardened Raceway
WR1635101	101.1	39.00	15.925	12.00	24.00	35.00	<b>BALL/ROLLER TYPE</b>
FPS72	181.36	54.10	19.050	19.050	63.25	38.100	Soft Shaft - Induction hardened Raceway
WR2552208	208	56.00	25.00	15.92	50.00	52.00	<b>BALL/ROLLER TYPE M14 THREAD 18MM LONG "C" END</b>