

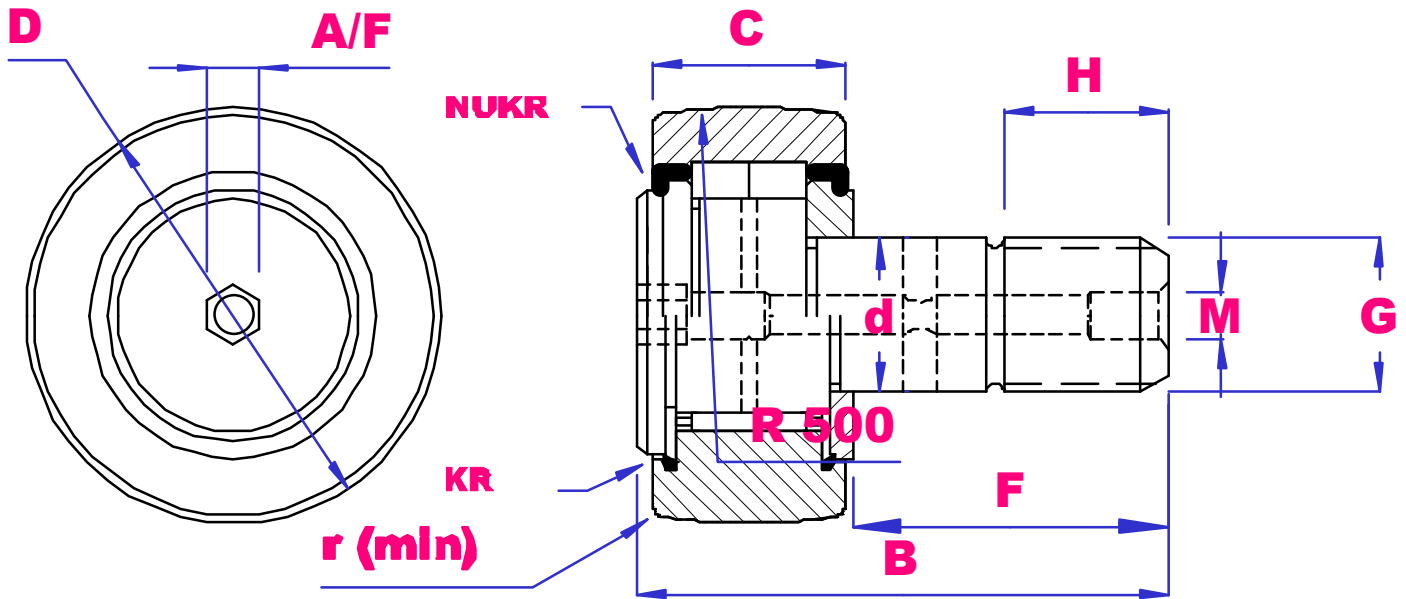

UBC METRIC CAMFOLLOWERS



PART NO	d	D	C	B	F	G	H	r min	M	Load D-kN	Load S-kN	Max rpm	Wgt g
KR16PP	6	16	11	28	16	M6X1	8	0.15	4	3.80	3.75	16000	18.5
KR19PP	8	19	11	32	20	M8X1.25	10	0.15	4	4.25	4.60	14000	28.5
KR22PP	10	22	12	36	23	M10X1	12	0.3	4	5.70	6.50	11000	45
KR26PP	10	26	12	36	23	M10X1	12	0.3	4	5.70	6.50	11000	60
KR30PP	12	30	14	40	25	M12X1.5	13	0.6	6	8.10	9.70	8300	95
KR32PP	12	32	14	40	25	M12X1.5	13	0.6	6	8.10	9.70	8300	105
KR35PP	16	35	18	52	32.5	M16X1.5	17	0.6	6	9.70	14.10	7200	182
NUKR35	16	35	18	52	32.5	M16X1.5	17	0.6	6	23.0	27.0	6500	164
NUKR40	18	40	20	58	36.5	M18X1.5	19	1.0	6	24.8	31.0	5500	242
NUKR47	20	47	24	66	40.5	M20X1.5	21	1.0	8	39.0	50.0	4200	380
NUKR52	20	52	24	66	40.5	M20X1.5	21	1.0	8	43.5	60.0	3400	450
NUKR62	24	62	29	80	49.5	M24X1.5	25	1.0	8	59.0	79.0	2600	795
NUKR72	24	72	29	80	49.5	M24X1.5	25	1.1	8	65.0	93.0	2100	1020
NUKR80	30	80	35	100	63	M30X1.5	32	1.1	8	95.0	133	1800	1600
NUKR90	30	90	35	100	63	M30X1.5	32	1.1	8	95.0	133	1800	1960