



UBC

BALL BEARINGS

10 - 20 MM ID



Quality
Endorsed
Company
ISO 9001:2000
LIC QEC20818

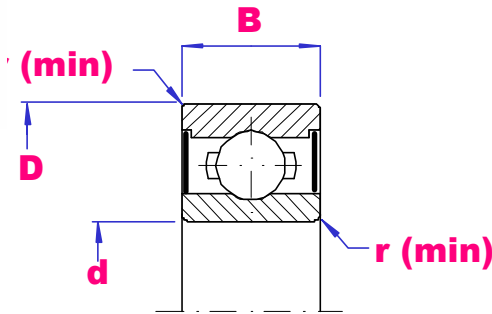

PART NO	d mm	D mm	B mm	r _{min} mm	Load D-kN	Load S-kN	Limiting speed			Wgt g
							Open/oil	zz	2rs	
6700	10	15	4	0.2	1.01	0.555	48000	36000	26000	1.1
6800		19	5	0.3	1.72	0.840	40000	34000	24000	5
6800B		19	7	0.3	1.72	0.840	40000	34000	24000	7
6900		22	6	0.3	2.70	1.270	38000	32000	22000	9
6000		26	8	0.3	4.55	1.970	36000	30000	22000	18
6200		30	9	0.6	5.10	2.390	30000	24000	18000	31
6300		35	11	0.6	8.10	3.450	26000	22000	17000	51
6701	12	18	4	0.3	1.07	0.655	44000	34000	22000	3
6801		21	5	0.3	1.92	1.040	38000	32000	20000	6
6901		24	6	0.3	2.89	1.460	36000	30000	20000	10
6001		28	8	0.3	5.10	2.370	32000	28000	18000	22
6201		32	10	0.6	6.80	3.050	28000	22000	17000	37
6301		37	12	1.0	9.70	4.200	24000	20000	16000	60
6702	15	21	4	0.3	1.15	0.790	40000	30000	18000	4
6802		24	5	0.3	2.07	1.260	34000	28000	17000	7
6902		28	7	0.3	4.35	2.260	30000	26000	17000	15
6002		32	9	0.3	5.60	2.830	28000	24000	15000	31
6202		35	11	0.6	7.65	3.750	24000	20000	14000	45
6302		42	13	1.0	11.4	5.450	20000	17000	13000	83
6703	17	23	4	0.3	1.20	0.865	34000	28000	16000	4
6803		26	5	0.3	2.63	1.570	30000	26000	15000	7
6903		30	7	0.3	4.60	2.550	28000	24000	15000	17
6003		35	10	0.3	6.00	3.250	26000	22000	13000	41
6203		40	12	0.6	9.55	4.800	20000	17000	12000	67
6303		47	14	1.0	13.6	6.650	18000	15000	11000	113
6403		62	17	1.1	22.5	11.45	17000	8500	7500	270
6704	20	27	4	0.3	1.79	1.32	30000	24000	14000	5
6804		32	7	0.3	4.00	3.47	26000	22000	13000	17
6904		37	9	0.3	6.40	3.70	22000	19000	12000	37
6004		42	12	0.6	9.40	5.00	20000	18000	11000	68
6204		47	14	1	12.8	6.60	18000	15000	10500	107
6304		52	15	1.1	15.9	7.90	17000	14000	10000	145
6404		72	19	1.1	30.5	14.9	14000	6500	5500	415